

A walk through
the research
paths of the
Department of
Architecture
of Florence

DIDA RESEARCH WEEK BOOK 2018



UNIVERSITÀ
DEGLI STUDI
FIRENZE

DIDA
DIPARTIMENTO DI
ARCHITETTURA

graphic design

didacommunicationlab

Dipartimento di Architettura
Università degli Studi di Firenze

Susanna Cerri
Stefania Aimar
Federica Giulivo
Simone Spellucci



didapress

Dipartimento di Architettura
Università degli Studi di Firenze
via della Mattonaia, 8 Firenze 50121

© 2019
ISBN 9788833380629

Printed on pure cellulose paper *Fedrigoni Arcoset*

ELEMENTAL
CHLORINE
FREE
GUARANTEED



HEAVY METAL
ABSENCE
CE 94/42



In February 2018, the Department of Architecture of the University of Florence (DIDA) promoted an open and public analysis and evaluation of the research carried out by the Department during its first five years of existence in order to define its strategy, the relationship with third and second cycle education, the role of experimental research and the DIDA-LABS laboratory system, as well as of research units and inter-university research centers.

The objective of the DIDA Research Week, through the documentation, communication and evaluation of the activities carried out by the Department in national and international research projects or in individual or exploratory projects, is an analysis and an in-depth reflection on the research activities at all levels carried out during the first five years of the Department: a wide and transparent reflection which communicates what the research carried out by DIDA is in all its different forms, calling the most qualified colleagues in Florence, Italy and abroad to discuss and to evaluate it and to contribute to the identification of future goals, strategies and actions.

The transparency strategy in scientific communication developed by the Department plays a central role not only concerning the dissemination of knowledge but above all for the effective evaluation by the entire scientific community, certainly more effective than the current assessment procedures. The increasingly international dimension of research and education requires the maximum possible transparency and accessibility of research results.

The Department's commitment to supporting scientific journals, the DIDAPress publishing, the Communication Laboratory and the first DIDA Research Week itself aims to meet this need.

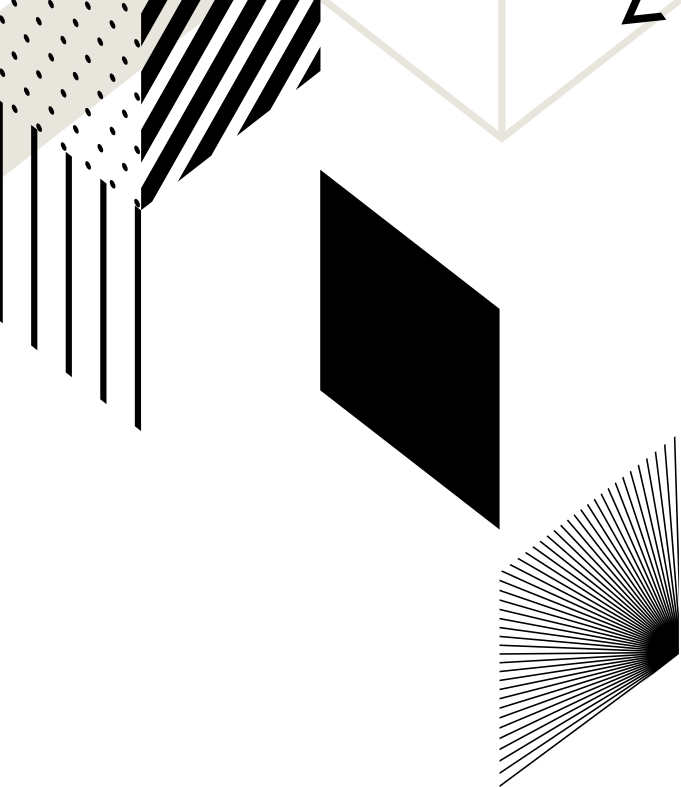

**DIDA RESEARCH WEEK 5 YEARS OF RESEARCH BY THE DEPARTMENT DIDA 2013-2017:
AN ASSESSMENT FOR THE FUTURE PROGRAM.**

19-23 February 2017

Santa Teresa, via della Mattonaia 8, 50121 Florence

Monday 19 February

Disciplinary research

Interdisciplinary and multidisciplinary research

Tuesday, February 20

Competitive research, horizon 2020, industrial research, design research,
research for the third mission

Research communication, magazines and scientific publishing

Wednesday 21 February

The Ph.D. Course in Architecture

Thursday 22 February

Research, training and profession. DIDALABS, Research Units and Research Centers

Applied research experiences

Round table: Research, training, profession: DIDA Open perspectives

Friday 23 February

Research, training and profession in the design area:
scenarios and strategies for the design and project area

DIDA RESEARCH WEEK
BOOK 2018



TABLE OF CONTENTS

INTRO

DIDA Research Week. Overview of DIDA research environment from 2013 up to 2018	15
Saverio Mecca	

Map 1 Research Map	18
---------------------------	----

DIDA RESEARCH STRATEGY | A general view

Projects and relations between fields of knowledge	23
Giuseppe Lotti	

Towards an innovative doctorate	27
Giuseppe De Luca	

Didalabs. Clusters and applied research	31
Giorgio Verdiani	

Map 2 DIDAlabs. Inside Research	34
--	----

Understanding research through communication. Concept, methodologies and tools of DRW	37
Susanna Cerri	

Setting Connections. Inter-university Centres	41
Roberto Bologna, Paola Gallo	

Map 3 Internationalisation of research	44
---	----

DIDA RESEARCH MAP | 2013-2018

DIDA Research Systems	55
------------------------------	-----------

Inter-university centres ABITA_CIST_TESIS	57
ABITA	
TESIS	

Laboratories	97
A&P - Architecture & Project cluster	99

Architecture and Auto-construction | LAA

Prato Laboratory | Laboratorioprato

Technologies for the Mediterranean Area Laboratory | TAM Lab

Theatre | Architecture Laboratory | TEARC Lab

Urban Design Laboratory | UD

AHCV - Architectural Heritage Conservation and Valorisation cluster	113
--	------------

Architectural Heritage Restoration and Conservation | LARC

Architectural Survey Laboratory | LRA architecturalsurveylab

Cultural Heritage Management Laboratory | CHM_Lab

Heritage City Laboratory | Heritage City_Lab

Materials and Structures Testing Laboratory | LPMS

DSI - Design and Sustainable Innovation cluster	143
Communication Laboratory didacommunicationlab	
Design for Kids	
Italian Design for the train DIT lab	
Ergonomics & Design Laboratory LED	
Modelling Laboratory for Design LMD lab	
Multimedia Architecture Interaction Laboratory mailab	
Reverse Engineering Interaction design Rei Lab	
Sustainable Design Laboratory sustainabilitylab	
ICT - Information Communication Technologies cluster	189
Informatic Laboratory of Architecture informaticlab - LiA	
Cartography Laboratory LCart	
Photography Laboratory LfA	
Architectural Model Laboratory LMA	
Architecture Video Laboratory VI.D.A. lab	
TEL - Territories, Ecosystems and Landscapes cluster	205
Critical Planning & Design	
Laboratory of Sociological Research on Design, Architecture and Planning LabSo	
Landscape Design Lab	
Laboratory of Ecological Design of Settlements LaPEI	
Plans and Projects for the City and the Territory PPCT	
Regional Design Lab	
PhD Programs	241
Architectural and Environmental Survey and Representation	
Design	
History of Architecture and the City	
Landscape Architecture	
Technology of Architecture	
Urban and Regional Planning and Design	
Research Units	305
Cities and Regions Across Local Boundaries A.VAST Area Vasta	
COmmunities REsilience CORE	
Documentation and Management of Small Historical Settlements DM_SHS	
Exploring Landscape Architecture ELA eu.med.	
Florence Accessibility Lab FAL	
Heritage and Euro-Mediterranean Design Dar_Med	
International Group on Urban and Architecture Design INTEGRO_UAD	
Landscape, Cultural Heritage. Project PPcP	
Local and Indigenous Knowledge Systems and Innovation INN-LINK-S	
Projects on Environment, Cities and Territories in the South ProjECTS	
Urban Bioregion Project PROBIUR	
Sustainable Urban Projects & Research SUP&R	
Technology for the Project TxP_R	

Scientific Journals	345
Firenze Architettura	
Contesti	
Territori	
Scienze del Territorio	
Opus Incertum	
Ri-Vista	
DIDA Research Programs	359
A&P - Architecture & Project	363
Architecture & Project	346
AHCV - Architectural Heritage Conservation and Valorisation	485
Architectural and Environmental Survey and Representation	486
Conservation of Architecture and Cultural Heritage	572
History of Architecture and the City	604
Materials and Structures	648
DSI - Design and Sustainable Innovation	697
Design	698
Technologies of Architecture	714
TEL - Territories, Ecosystems and Landscapes	745
Landscape Architecture	746
Urban and Regional Planning and Design	752



TESIS

AOU-SIENA

Accessibility monitoring of the hospital Le Scotte - Siena

Scientific Coordinators
Maria Chiara Torricelli
Luca Marzi

Address
DIDA
San Niccolò
AOUS
Ospedale le Scotte (SI)

Research Group
DIDA-UNIFI
Maria Chiara Torricelli
Luca Marzi
Nicoletta Setola
Elena Bellini
Federica Parente

AOUS
Silvio Marsicano
Filippo Terzaghi
Paola Ricci
Alessandra Panichi
Marco Geddes
Cristina Degli Innocenti

The issue of accessibility and safety in public health services is explicitly addressed in many of the analysis and verification procedures for performance and quality assurance, as well as in specific regulatory guidance: are remembered the D.P.C.M. 19 May 1995 (Charter for public health services), the quality assessment systems, like those AGENAS (Agenzia Nazionale per i Servizi Sanitari Regionali) and recent analysis campaigns defined in the framework of specific studies such as the cognitive survey on the hospital pathways of people with disabilities, carried out by the National Observatory on Health in the Italian regions.

The Tesis Centre, in agreement with the University Hospital of the Scotte in Siena, has defined an operational plan, realized in 3 macro phases, with the aim of defining a plan of the interventions necessary for the attenuation/overcoming of the “architectural barriers”.

The Objectives of the research programme can be summarised as:

- Realization of an intervention model (system for overcoming architectural barriers);
- Definition of methods of verification and monitoring of the system for overcoming architectural barriers. Coordination with safety planning for users and medical professionals.

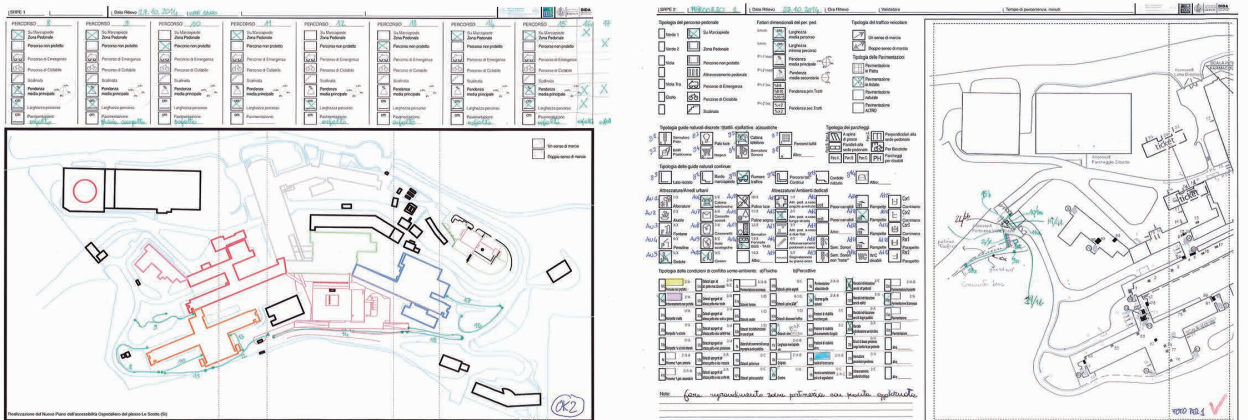
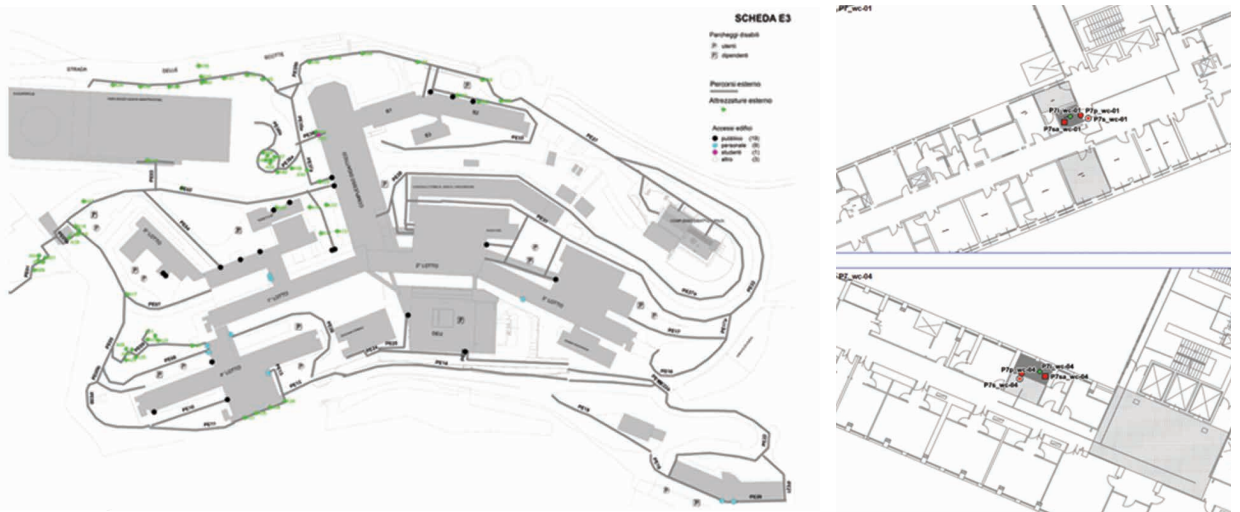

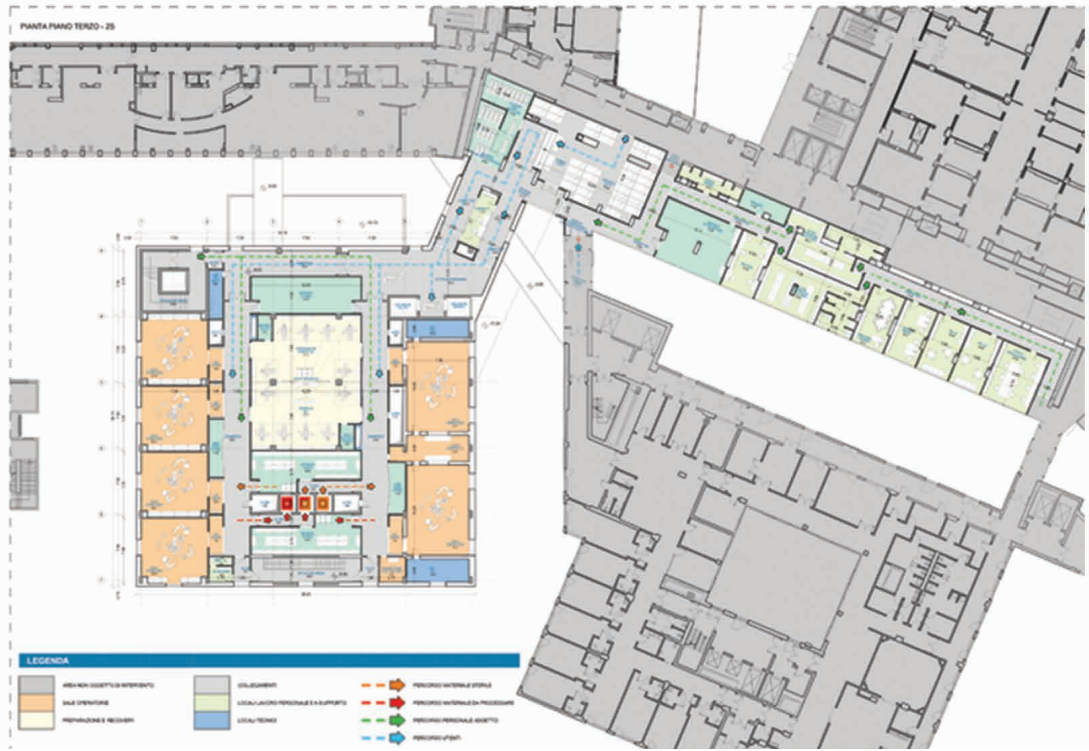
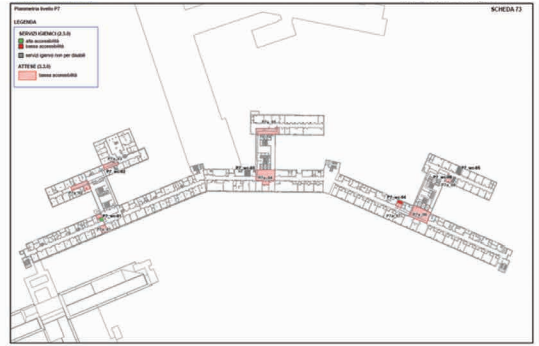

1 @ 16,7% (Livello 1, RGB8) * Piano dell'accessibilità Ospedaliero del plesso Le Scotte (SI)

Rilevato effettuato in data Giugno 2015
Arch. Luca Marzi, Arch. Nicoletta Setola, Arch. Elena Bellini



SCHEDA 42

	classe	tipo fruibili	uso	stato manutentivo	larghezza wc	lunghezza wc	larghezza antiwc	lunghezza antiwc	altezza minima	accostamento wc	accostamento lavabo	approcci wc	manutenzione pav	pendenza	soglie	scivolosità	risalti	rilievi
P1_wc-01	c	c	f		2.3.1	2.3.2	2.3.3	2.3.4	2.3.5	2.3.6	2.3.7	2.3.8	2.4.1	2.4.2	2.4.3	2.4.4	2.4.5	2.4.6
Attese piano P1																		
	tipo sedute	pres. info	prot. accetti disab	altezza bancone	segnale-tica	segnal. sonora												
P1a_01	b	b	f	f	b	f												
Sanitari WC piano P1																		
	lavabi	wc bidet	bordo ant	bordo superiore	corrimano	rubinetti	saponi	specchio	lavandino	tipo chiusura	campanello	verifica chiamata						
	2.8.1	2.8.2	2.8.3	2.8.4	2.8.5	2.8.6	2.8.7	2.8.8	2.8.9	2.8.10	2.8.11	2.8.12						
Illuminazione WC piano P1																		
	manute ill. diurna	ill. artificiale	mancaza illuminaz.						Segnaletica WC piano P1									
	2.7.1	2.7.2	2.7.3	2.7.4						mappe tattili antistanti								
										2.5.1				2.5.2				
Porte WC piano P1																		
	manute diso	tipo_var co	tipo_p_orte	lup_libero	lup_potenziale	alt_infisso	Disl_soglia	Tipo_man	Alt_man	Peso								
	2.6.1	2.6.2	2.6.3	2.6.6	2.6.7	2.6.8	2.6.9	2.6.12	2.6.13	2.6.14								



UNIVERSITÀ
DEGLI STUDI
FIRENZE

DIDA, the Department of Architecture of the University of Florence, performed an open and public analysis and evaluation of the scientific research carried out during the first five years of activity since its establishment, in order to define its research strategies, their relationship with the 2nd and 3rd cycle education, the role of experimental research and the system of labs at DIDA (DIDALABS), as well as the role of research units and interuniversity research centers.

The aim of the DIDA Research Week Book 2018 is to communicate the results of such research, in all the aspects which were carried out at DIDA during its first five years of activity.

ISBN 978-88-3338-062-9



9 788833 380629