

A walk through  
the research  
paths of the  
Department of  
Architecture  
of Florence

# DIDA RESEARCH WEEK BOOK 2018









**DIDA**  
RESEARCH  
WEEK  
**BOOK**  
2018

A walk through the research  
paths of the Department of  
Architecture of Florence





UNIVERSITÀ  
DEGLI STUDI  
FIRENZE

**DIDA**  
DIPARTIMENTO DI  
ARCHITETTURA

*graphic design*

**didacommunicationlab**

Dipartimento di Architettura  
Università degli Studi di Firenze

Susanna Cerri  
Stefania Aimar  
Federica Giulivo  
Simone Spellucci



**didapress**

Dipartimento di Architettura  
Università degli Studi di Firenze  
via della Mattonaia, 8 Firenze 50121

© 2019  
ISBN 9788833380629

Printed on pure cellulose paper *Fedrigoni Arcoset*

ELEMENTAL  
CHLORINE  
**FREE**  
GUARANTEED





In February 2018, the Department of Architecture of the University of Florence (DIDA) promoted an open and public analysis and evaluation of the research carried out by the Department during its first five years of existence in order to define its strategy, the relationship with third and second cycle education, the role of experimental research and the DIDA-LABS laboratory system, as well as of research units and inter-university research centers.

The objective of the DIDA Research Week, through the documentation, communication and evaluation of the activities carried out by the Department in national and international research projects or in individual or exploratory projects, is an analysis and an in-depth reflection on the research activities at all levels carried out during the first five years of the Department: a wide and transparent reflection which communicates what the research carried out by DIDA is in all its different forms, calling the most qualified colleagues in Florence, Italy and abroad to discuss and to evaluate it and to contribute to the identification of future goals, strategies and actions.

The transparency strategy in scientific communication developed by the Department plays a central role not only concerning the dissemination of knowledge but above all for the effective evaluation by the entire scientific community, certainly more effective than the current assessment procedures. The increasingly international dimension of research and education requires the maximum possible transparency and accessibility of research results.

The Department's commitment to supporting scientific journals, the DIDAPress publishing, the Communication Laboratory and the first DIDA Research Week itself aims to meet this need.

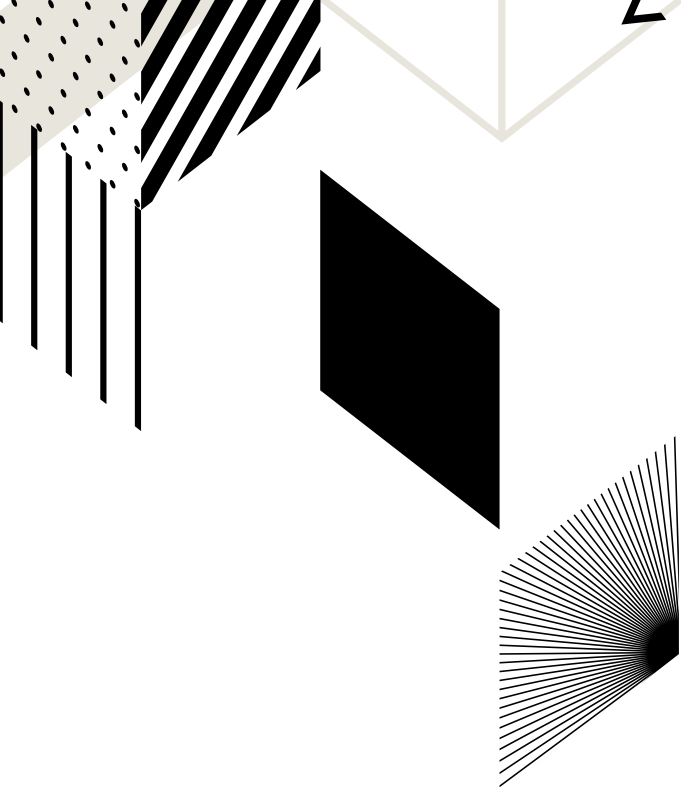

**DIDA RESEARCH WEEK 5 YEARS OF RESEARCH BY THE DEPARTMENT DIDA 2013-2017:  
AN ASSESSMENT FOR THE FUTURE PROGRAM.**

**19-23 February 2017**

Santa Teresa, via della Mattonaia 8, 50121 Florence

**Monday 19 February**

Disciplinary research

Interdisciplinary and multidisciplinary research

**Tuesday, February 20**

Competitive research, horizon 2020, industrial research, design research,  
research for the third mission

Research communication, magazines and scientific publishing

**Wednesday 21 February**

The Ph.D. Course in Architecture

**Thursday 22 February**

Research, training and profession. DIDALABS, Research Units and Research Centers

Applied research experiences

*Round table:* Research, training, profession: DIDA Open perspectives

**Friday 23 February**

Research, training and profession in the design area:  
scenarios and strategies for the design and project area



DIDA RESEARCH WEEK  
**BOOK 2018**





## TABLE OF CONTENTS

### INTRO

<b>DIDA Research Week. Overview of DIDA research environment from 2013 up to 2018</b>	<b>15</b>
Saverio Mecca	

<b>Map 1</b> Research Map	18
---------------------------	----

### DIDA RESEARCH STRATEGY | A general view

<b>Projects and relations between fields of knowledge</b>	<b>23</b>
Giuseppe Lotti	

<b>Towards an innovative doctorate</b>	<b>27</b>
Giuseppe De Luca	

<b>Didalabs. Clusters and applied research</b>	<b>31</b>
Giorgio Verdiani	

<b>Map 2</b> DIDAlabs. Inside Research	34
--	----

<b>Understanding research through communication. Concept, methodologies and tools of DRW</b>	<b>37</b>
Susanna Cerri	

<b>Setting Connections. Inter-university Centres</b>	<b>41</b>
Roberto Bologna, Paola Gallo	

<b>Map 3</b> Internationalisation of research	44
---	----

### DIDA RESEARCH MAP | 2013-2018 **47**

#### DIDA Research Systems **55**

<b>Inter-university centres ABITA_CIST_TESIS</b>	<b>57</b>
ABITA	
TESIS	

#### Laboratories **97**

##### A&P - Architecture & Project cluster **99**

Architecture and Auto-construction | LAA

Prato Laboratory | Laboratorioprato

Technologies for the Mediterranean Area Laboratory | TAM Lab

Theatre | Architecture Laboratory | TEARC Lab

Urban Design Laboratory | UD

##### AHCV - Architectural Heritage Conservation and Valorisation cluster **113**

Architectural Heritage Restoration and Conservation | LARC

Architectural Survey Laboratory | LRA architecturalsurveylab

Cultural Heritage Management Laboratory | CHM\_Lab

Heritage City Laboratory | Heritage City\_Lab

Materials and Structures Testing Laboratory | LPMS

<b>DSI - Design and Sustainable Innovation cluster</b>	<b>143</b>
Communication Laboratory   didacommunicationlab	
Design for Kids	
Italian Design for the train   DIT lab	
Ergonomics & Design Laboratory   LED	
Modelling Laboratory for Design   LMD lab	
Multimedia Architecture Interaction Laboratory   mailab	
Reverse Engineering Interaction design   Rei Lab	
Sustainable Design Laboratory   sustainabilitylab	
<b>ICT - Information Communication Technologies cluster</b>	<b>189</b>
Informatic Laboratory of Architecture   informaticlab - LiA	
Cartography Laboratory   LCart	
Photography Laboratory   LfA	
Architectural Model Laboratory   LMA	
Architecture Video Laboratory   VI.D.A. lab	
<b>TEL - Territories, Ecosystems and Landscapes cluster</b>	<b>205</b>
Critical Planning & Design	
Laboratory of Sociological Research on Design, Architecture and Planning   LabSo	
Landscape Design Lab	
Laboratory of Ecological Design of Settlements   LaPEI	
Plans and Projects for the City and the Territory   PPCT	
Regional Design Lab	
<b>PhD Programs</b>	<b>241</b>
Architectural and Environmental Survey and Representation	
Design	
History of Architecture and the City	
Landscape Architecture	
Technology of Architecture	
Urban and Regional Planning and Design	
<b>Research Units</b>	<b>305</b>
Cities and Regions Across Local Boundaries   A.VAST Area Vasta	
COmmunities REsilience   CORE	
Documentation and Management of Small Historical Settlements   DM_SHS	
Exploring Landscape Architecture   ELA eu.med.	
Florence Accessibility Lab   FAL	
Heritage and Euro-Mediterranean Design   Dar_Med	
International Group on Urban and Architecture Design   INTEGRO_UAD	
Landscape, Cultural Heritage. Project   PPcP	
Local and Indigenous Knowledge Systems and Innovation   INN-LINK-S	
Projects on Environment, Cities and Territories in the South   ProjECTS	
Urban Bioregion Project   PROBIUR	
Sustainable Urban Projects & Research   SUP&R	
Technology for the Project   TxP_R	

<b>Scientific Journals</b>	<b>345</b>
Firenze Architettura	
Contesti	
Territori	
Scienze del Territorio	
Opus Incertum	
Ri-Vista	
<b>DIDA Research Programs</b>	<b>359</b>
<b>A&amp;P - Architecture &amp; Project</b>	<b>363</b>
Architecture & Project	346
<b>AHCV - Architectural Heritage Conservation and Valorisation</b>	<b>485</b>
Architectural and Environmental Survey and Representation	486
Conservation of Architecture and Cultural Heritage	572
History of Architecture and the City	604
Materials and Structures	648
<b>DSI - Design and Sustainable Innovation</b>	<b>697</b>
Design	698
Technologies of Architecture	714
<b>TEL - Territories, Ecosystems and Landscapes</b>	<b>745</b>
Landscape Architecture	746
Urban and Regional Planning and Design	752

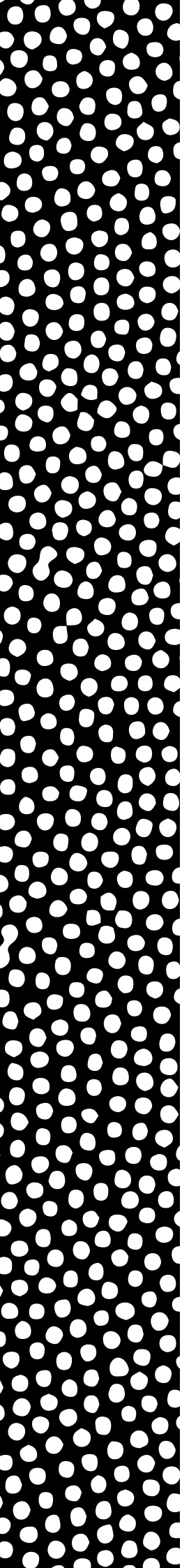



**DIDA Research**

**Programs**

# Made of vines and stone

## Architectural and environmental design for a winery

**RESEARCH AGREEMENT**

**Scientific Coordinator**  
Michelangelo Pivetta

**Collaborators**  
Davide Lucia  
Elisa Monaci  
Luisa Palermo

Bacchus is known to be an insidious god. The rituals dedicated to him for someone, usually, did not end well. The dynamics of the land east of Verona, compressed between the Pre-Alps and Lake Garda, carved by the wound of the Adige, communicate a healthy resistance of the farmer to open the oak doors of his cellar and spread the secrets of his work. He has nothing to hide but the wine he produces is the fruit of his land, his work, the ancient wisdom of his families. There is an acute sense of ownership linked to the sense of roots among those who make wine for passion as well as for work. In Valpolicella the cellars are hundreds of years old and are the caveau where the purest part of their bond with the land and the stone that built them is collected; the substance of everything.

These aspects have found a way to channel into critical thinking, becoming the basis for this architectural design. The cellar designed is the result of a work whose project is only the last offshoot, it summarizes an ideal position of architecture in its broad comparison with the themes of industry and territory, settlement and landscape, agricultural work and its proud manifestation.

The cellar, the productive part, is only a trick to talk about something else, to show off not only itself as too often happens. The design aims to be the tool through which to tell millennia of wine culture and stone excavation, modification of the natural landscape in agricultural landscape, human work on a context that from the agricultural and quarries built the Arena traces have made a true archaeologies.

What emerges in the end is just another wall, another among many others, made of the same stone that was always quarried but built according to new rules of technology. Next, by necessity, to the discourse of non-form. This wall is not substructure of earth like its progenitors but container; temple of the peculiar art of the withering of the berries. A functional transit as for the gestation of Bacchus, from the womb of Semel to the leg of Jupiter, from the land of the vine to the stone of the building.

Architecture needs to express itself through opportunities for dialogue with the elements that determine its boundaries, whatever nature they are made, because only in this way it is able to tell, like in this case, true and great stories.

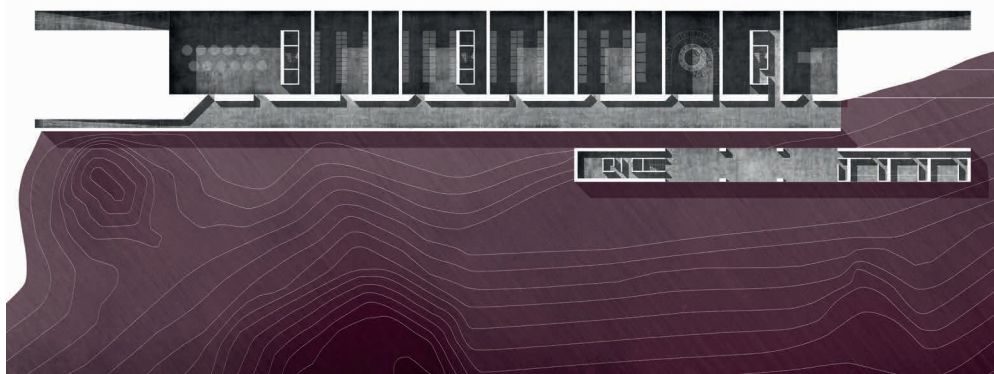
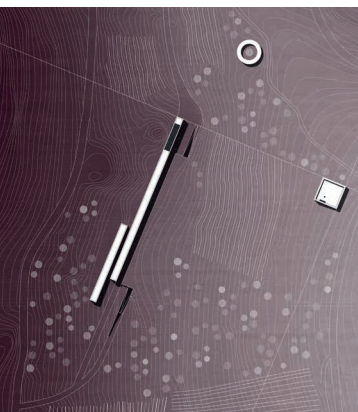



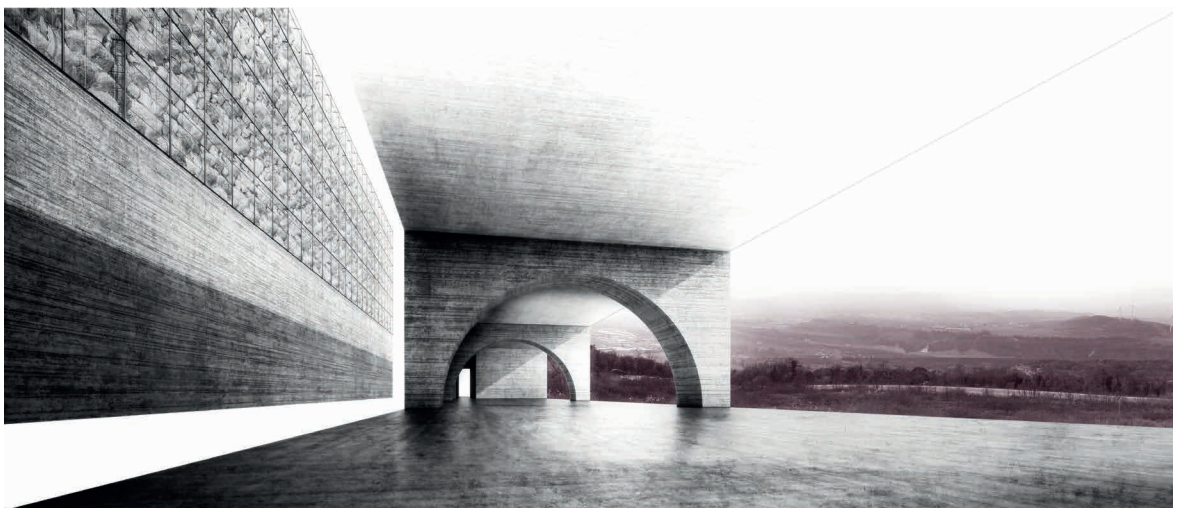
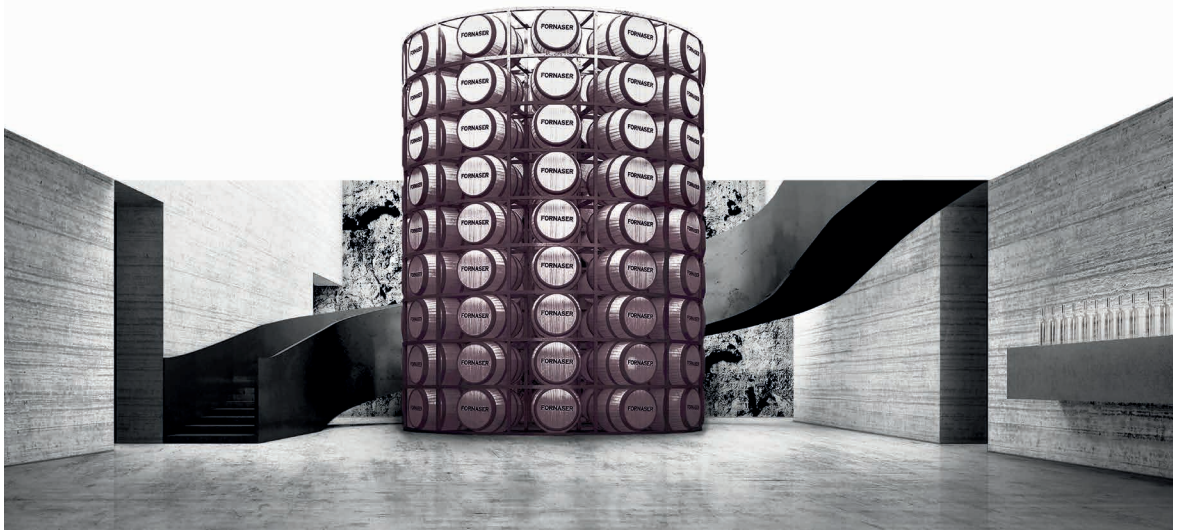



Printed by  
Rubbettino Print | Soveria Mannelli (CZ)  
for **didapress**  
**Dipartimento di Architettura**  
Università degli Studi di Firenze  
April 2019





UNIVERSITÀ  
DEGLI STUDI  
FIRENZE

DIDA, the Department of Architecture of the University of Florence, performed an open and public analysis and evaluation of the scientific research carried out during the first five years of activity since its establishment, in order to define its research strategies, their relationship with the 2nd and 3rd cycle education, the role of experimental research and the system of labs at DIDA (DIDALABS), as well as the role of research units and interuniversity research centers.

The aim of the DIDA Research Week Book 2018 is to communicate the results of such research, in all the aspects which were carried out at DIDA during its first five years of activity.

ISBN 978-88-3338-062-9



9 788833 380629